

**VERSCHLUSS - KUPPLUNG / **RELEASE COUPLING****



VERSCHLUSS - KUPPLUNG / RELEASE COUPLING

KAPITEL 19 Übersicht

SECTION 19 Visual Index

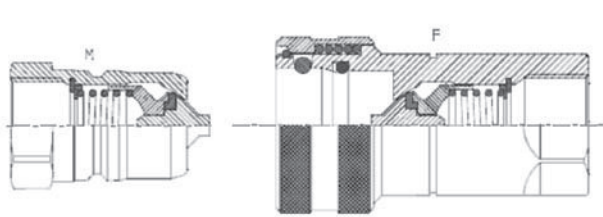

ISO 7241-1B-Strd. 19.02

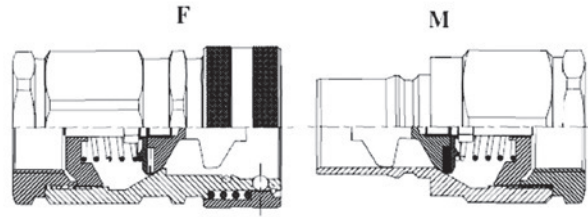

ISO 7241-1B-Big Size 19.03

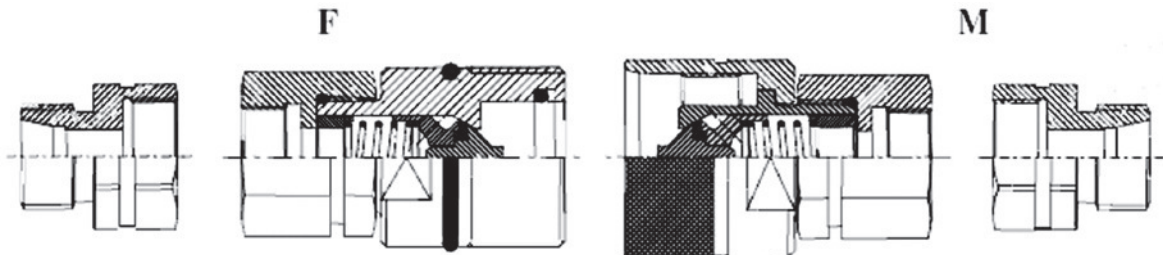

Serie " 30 " 19.04

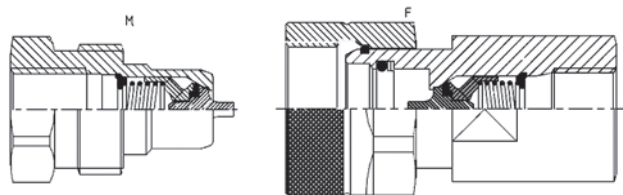

Serie " 40 " 19.05

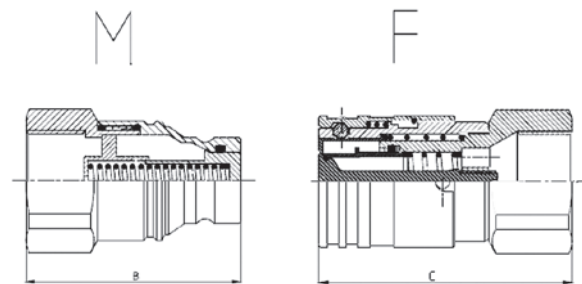

ISO 16028-Strd. 19.06

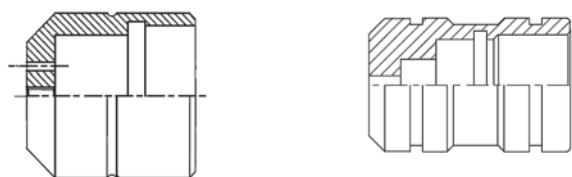

Staubkappe/Stecker 19.07

## SCHNELLVERSCHLUSS - KUPPLUNG / QUICK RELEASE COUPLING

### QRC

Schnellverschluss-Kupplung  
ISO 7241-1B, Standard  
mit beidseitigem Innengewinde  
Gewinde: Whitworth-Rohrgewinde-zyl.

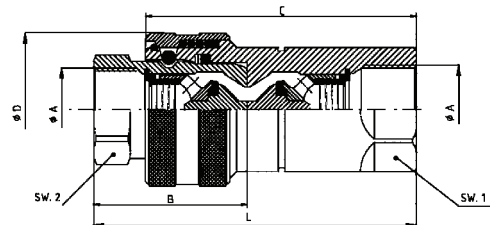

### QRC

Quick Release Coupling  
ISO 7241-1B, Standard  
With Female Thread Both Sides  
Thread: BSPP

$\phi A$ inch	B mm	C mm	D mm	L mm	SW 1 mm	SW 2 mm	PN bar	Gewicht weight gr.	Bezeichnung name	Artikel-Nr.: article no.
1/8"-04	31	50	24	62	14	14	300	110	QRC - ISO 7241-1B - 1/8"-04	208472
1/4"-06	36	57	28	72	19	19	300	170	QRC - ISO 7241-1B - 1/4"-06	208439
3/8"-09	39	64	35	78	24	24	250	290	QRC - ISO 7241-1B - 3/8"-09	208440
1/2"-13	45,5	73	42	91	27	27	250	500	QRC - ISO 7241-1B - 1/2"-13	208441
3/4"-19	53,5	87	51,5	107	36	36	250	850	QRC - ISO 7241-1B - 3/4"-19	208442
1"-25	63	102	60	125	41	41	200	1250	QRC - ISO 7241-1B - 1"-25	208443

Stecker / male

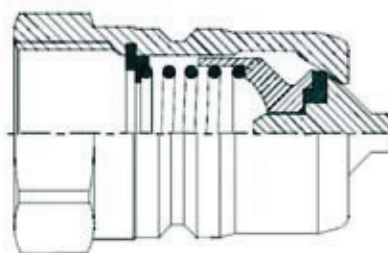

Bezeichnung name	Artikel-Nr.: article no.
KS - ISO 7241-1B - 1/8"-04	203303
KS - ISO 7241-1B - 1/4"-06	204300
KS - ISO 7241-1B - 3/8"-09	204301
KS - ISO 7241-1B - 1/2"-13	204302
KS - ISO 7241-1B - 3/4"-19	204303
KS - ISO 7241-1B - 1"-25	204304

Muffe / female

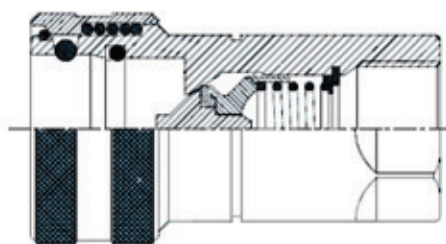

Bezeichnung name	Artikel-Nr.: article no.
KM - ISO 7241-1B - 1/8"-04	208470
KM - ISO 7241-1B - 1/4"-06	204259
KM - ISO 7241-1B - 3/8"-09	204267
KM - ISO 7241-1B - 1/2"-13	204296
KM - ISO 7241-1B - 3/4"-19	126326
KM - ISO 7241-1B - 1"-25	204299

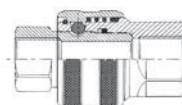

Durchlass-Kupplung ebenfalls lieferbar  
Unvalved (Straight Through) Couplings Too

Werkstoff: Edelstahl AISI 316  
Innentteile: 316 SS (Federn, Ringe, Kugeln)  
Dichtungen: PTFE (Viton auf Anfrage)  
Berstdruck: 2,5 x PN  
Andere Gewinde auf Anfrage

Material: Stainless Steel AISI 316  
Inner Components: 316 SS (Springs, Rings, Balls)  
Seals: PTFE (Viton On Request)  
Burstpressure: 2,5 x PN  
Other Threads On Request

**SCHNELLVERSCHLUSS - KUPPLUNG / QUICK RELEASE COUPLING**

**QRC**

Schnellverschluss-Kupplung  
ISO 7241-1B, Big Size  
mit beidseitigem Innengewinde  
Gewinde: Whitworth-Rohrgewinde-zyl.

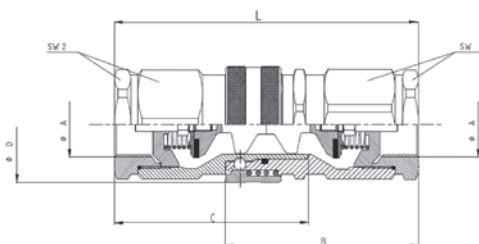

**QRC**

Quick Release Coupling  
ISO 7241-1B, Big Size  
With Female Thread Both Sides  
Thread: BSPP

ø A inch	B mm	C mm	D mm	L mm	SW 1 mm	SW 2 mm	PN bar	Gewicht weight gr.	Bezeichnung name	Artikel-Nr.: article no.
1.1/4"-30	126	126	75	198	65	65	140	3700	QRC - ISO 7241-1B - 1.1/4"-30	208466
1.1/2"-40	126	126	75	198	65	65	140	3700	QRC - ISO 7241-1B - 1.1/2"-40	208467
2"-50	142	142	105	222	90	90	90	8000	QRC - ISO 7241-1B - 2"-50	208468

**Stecker / male**

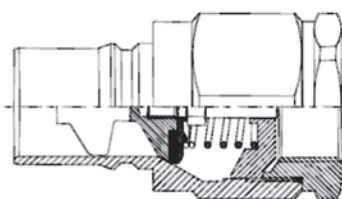

Bezeichnung name	Artikel-Nr.: article no.
KS - ISO 7241-1B - 1.1/4"-30	126817
KS - ISO 7241-1B - 1.1/2"-40	126818
KS - ISO 7241-1B - 2"-50	126819

**Muffe / female**

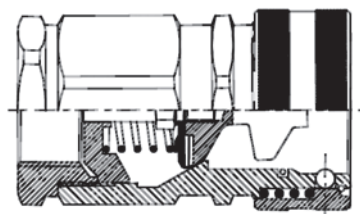

Bezeichnung name	Artikel-Nr.: article no.
KM - ISO 7241-1B - 1.1/4"-30	126814
KM - ISO 7241-1B - 1.1/2"-40	126815
KM - ISO 7241-1B - 2"-50	126816

Werkstoff: **Edelstahl AISI 316**  
Innenteile: 316 SS (Federn, Ringe, Kugeln)  
Dichtungen: PTFE (Viton auf Anfrage)  
Berstdruck: 2,5 x PN  
Andere Gewinde auf Anfrage

Material: **Stainless Steel AISI 316**  
Inner Components: 316 SS (Springs, Rings, Balls)  
Seals: PTFE (Viton On Request)  
Burstpressure: 2,5 x PN  
Other Threads On Request

## SCHRAUB - KUPPLUNG / SCREW COUPLING

### SC

Schraub-Kupplung

Serie " 30 "

mit beidseitigem Innengewinde

Gewinde: Whitworth-Rohrgewinde-zyl.

Schraubverschluss unter Druck montierbar

### SC

Screw Coupling

Series " 30 "

With Female Thread Both Sides

Thread: BSPP

Connection Under Pressure Mountable

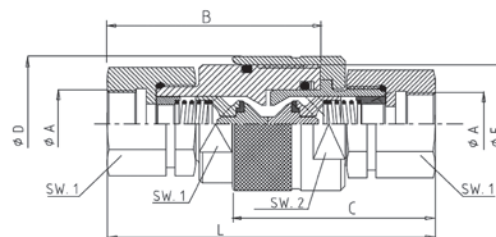

ø A inch	B mm	C mm	D mm	L mm	SW 1 mm	SW 2 mm	E mm	PN bar	Gewicht weight gr.	Bezeichnung name	Artikel-Nr.: article no.
1/4"-06	59	58	30	92	19	27	M24x2	300	220	SC - Serie 30 - 1/4"-06	208444
3/8"-09	64,5	62	34	100	22/24	30	M28x2	250	340	SC - Serie 30 - 3/8"-09	208445
1/2"-13	67	63	42	102	30	38	M36x2	250	600	SC - Serie 30 - 1/2"-13	208446
3/4"-19	82	75	48	136	36	41	M42x2	250	980	SC - Serie 30 - 3/4"-19	208447
1"-25	95	78,5	55	138	41	50	M48x3	250	1300	SC - Serie 30 - 1"-25	208448
1.1/2"-40	116	107	70	187	60	65	M70x3	200	4200	SC - Serie 30 - 1.1/2"-40	208449

Stecker / male

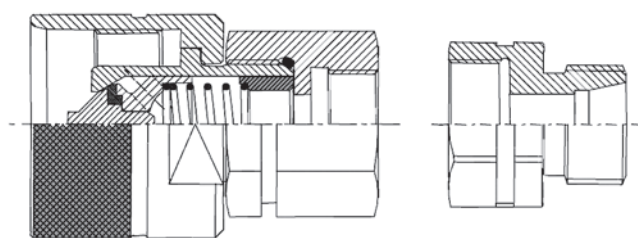

Bezeichnung name	Artikel-Nr.: article no.
SKS - Serie 30 - 1/4"-06	126828
SKS - Serie 30 - 3/8"-09	126827
SKS - Serie 30 - 1/2"-13	126829
SKS - Serie 30 - 3/4"-19	126830
SKS - Serie 30 - 1"-25	126831
SKS - Serie 30 - 1.1/2"-40	208479

Muffe / female

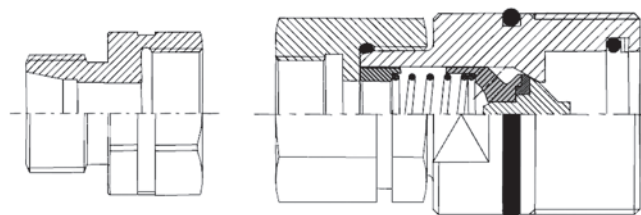

Bezeichnung name	Artikel-Nr.: article no.
SKM - Serie 30 - 1/4"-06	126832
SKM - Serie 30 - 3/8"-09	126833
SKM - Serie 30 - 1/2"-13	126834
SKM - Serie 30 - 3/4"-19	126835
SKM - Serie 30 - 1"-25	126836
SKM - Serie 30 - 1.1/2"-40	208480

Werkstoff: Edelstahl AISI 316

Innenteile: 316 SS (Federn, Ringe)

Dichtungen: PTFE (Viton auf Anfrage)

Berstdruck: 2,5 x PN

Aussen- und Innengewinde in verschiedenen Größen lieferbar

Material:

Stainless Steel AISI 316

Inner Components:

316 SS (Springs, Rings)

Seals:

PTFE (Viton On Request)

Burstpressure:

2,5 x PN

Male Or Female End With Different Thread Size Deliverable

## SCHRAUB - KUPPLUNG / SCREW COUPLING

### SC

Schraub-Kupplung

Serie " 40 "

mit beidseitigem Innengewinde

Gewinde:Whitworth-Rohrgewinde-zyl.

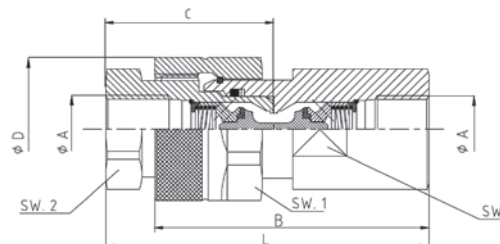

### SC

Screw Coupling

Series " 40 "

With Female Thread Both Sides

Thread:BSPP

ø A inch	B mm	C mm	D mm	L mm	SW 1 mm	SW 2 mm	SW 3 mm	PN bar	Gewicht weight gr.	Bezeichnung name	Artikel-Nr.: article no.
1/4"-06	68	43	30	84	27	25	22	650	300	SC - Serie 40 - 1/4"-06	208450
3/8"-09	75	48	40	89,5	36	32	27	650	550	SC - Serie 40 - 3/8"-09	208451
1/2"-13	86,5	53	45	102	41	34	34	600	780	SC - Serie 40 - 1/2"-13	208452
3/4"-19	105	63	55	121	50	46	41	500	1400	SC - Serie 40 - 3/4"-19	208453
1"-25	120	72	60	136	55	50	50	460	2400	SC - Serie 40 - 1"-25	208454
1.1/4"-30	153	86	80	167	75	65 *	65	400	3900	SC - Serie 40 - 1.1/4"-30	208455
1.1/2"-40	172	95	98	188	90	80 *	75	360	6400	SC - Serie 40 - 1.1/2"-40	208456
2"-50	205	118	129	227	125	110 *	100	210	13900	SC - Serie 40 - 2"-50	208457

\* = 2-Kant

\* = 2 Faces

Stecker / male

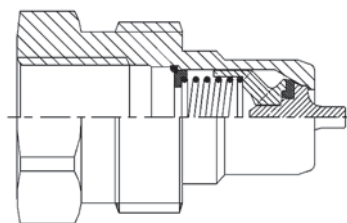

Muffe / female

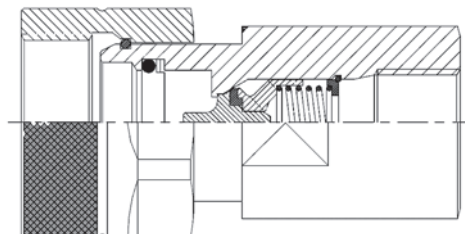

Bezeichnung name	Artikel-Nr.: article no.
SKS - Serie 40 - 1/4"-06	208481
SKS - Serie 40 - 3/8"-09	208482
SKS - Serie 40 - 1/2"-13	208483
SKS - Serie 40 - 3/4"-19	208484
SKS - Serie 40 - 1"-25	208485
SKS - Serie 40 - 1.1/4"-30	208486
SKS - Serie 40 - 1.1/2"-40	208487
SKS - Serie 40 - 2"-50	208488

Bezeichnung name	Artikel-Nr.: article no.
SKM - Serie 40 - 1/4"-06	208489
SKM - Serie 40 - 3/8"-09	208490
SKM - Serie 40 - 1/2"-13	208491
SKM - Serie 40 - 3/4"-19	208492
SKM - Serie 40 - 1"-25	208493
SKM - Serie 40 - 1.1/4"-30	208494
SKM - Serie 40 - 1.1/2"-40	208495
SKM - Serie 40 - 2"-50	208496

Werkstoff: Edelstahl AISI 316

Innenteile: 316 SS (Federn, Ringe)

Dichtungen: PTFE (Viton auf Anfrage)

Berstdruck: 2,5 x PN

Spezial Aluminium Staubkappen lieferbar

Material: Stainless Steel AISI 316

Inner Components: 316 SS (Springs, Rings)

Seals: PTFE (Viton On Request)

Burstpressure: 2,5 x PN

Special Aluminium Dust Cover Deliverable

## FLAT FACE - KUPPLUNG / FLAT FACE COUPLING

### FF

Flat Face-Kupplung  
ISO 16028 Standard  
mit beidseitigem Innengewinde  
Gewinde: Whitworth-Rohrgewinde-zyl.  
Integrierte Sicherheitsvorrichtung

### FF

Flat Face Coupling  
ISO 16028 Standard  
With Female Thread Both Sides  
Thread: BSPP  
Safety Block Device

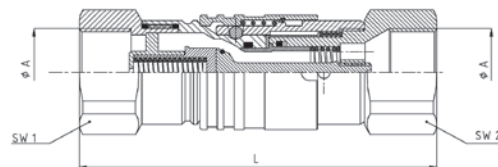

$\phi A$ inch	B mm	C mm	L mm	SW 1 mm	SW 2 mm	PN bar	Gewicht weight gr.	Bezeichnung name	Artikel-Nr.: article no.
1/4"-06	48	48	86	22	22	300	250	FF - ISO 16028 - 1/4"-06	208458
3/8"-09	67	68	118	27	27	250	400	FF - ISO 16028 - 3/8"-09	208459
1/2"-13	68	74	125	32	32	250	650	FF - ISO 16028 - 1/2"-13	208460
3/4"-19	70	79	130	36	36	200	750	FF - ISO 16028 - 3/4"-19	208461
1"-25	82	93	153	45	45	150	1200	FF - ISO 16028 - 1"-25	208462
1.1/4"-30	90	106	172,5	55	55	100	1950	FF - ISO 16028 - 1.1/4"-30	208463
1.1/2"-40	112	132,5	173	65	65	90	4500	FF - ISO 16028 - 1.1/2"-40	208464
2"-50	124	157	242	75	75	60	8500	FF - ISO 16028 - 2"-50	208465

Stecker / male

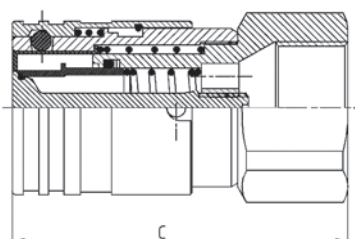

Bezeichnung name	Artikel-Nr.: article no.
FKS - ISO 16028 - 1/4"-06	208497
FKS - ISO 16028 - 3/8"-09	208498
FKS - ISO 16028 - 1/2"-13	208499
FKS - ISO 16028 - 3/4"-19	208500
FKS - ISO 16028 - 1"-25	208501
FKS - ISO 16028 - 1.1/4"-30	208502
FKS - ISO 16028 - 1.1/2"-40	208503
FKS - ISO 16028 - 2"-50	208504

Muffe / female

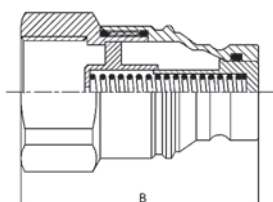

Bezeichnung name	Artikel-Nr.: article no.
FKM - ISO 16028 - 1/4"-06	208505
FKM - ISO 16028 - 3/8"-09	208506
FKM - ISO 16028 - 1/2"-13	208507
FKM - ISO 16028 - 3/4"-19	208508
FKM - ISO 16028 - 1"-25	208509
FKM - ISO 16028 - 1.1/4"-30	208510
FKM - ISO 16028 - 1.1/2"-40	208511
FKM - ISO 16028 - 2"-50	208512

Werkstoff: Edelstahl AISI 316  
Innentteile: 316 SS (Federn, Ringe)  
Dichtungen: PTFE (Viton auf Anfrage)  
Vollständige Abdichtung - kein Luftdurchlass  
Anwendbar wenn vollständige Abdichtung erforderlich ist

Material: Stainless Steel AISI 316  
Inner Components: 316 SS (Springs, Rings)  
Seals: PTFE (Viton On Request)  
Complete Seal - No Air Inclusion During Connection  
Application Where Leaks Aren't Allowed For Safety Reasons

**STAUB - ABDECKUNG / DUST COVER**

**STAUBABDECKUNG**

Stecker und Kappe  
 Werkstoff: Aluminium (Standard)  
 316 SS auf Anfrage  
 PVC auf Anfrage

**DUST COVER**

Male And Female  
 Material: Aluminium (Standard)  
 316 SS On Request  
 PVC On Request

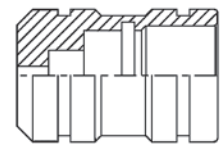
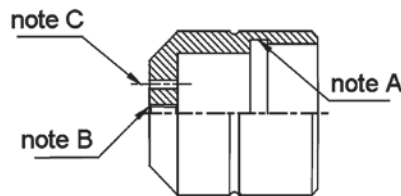
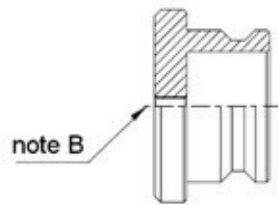
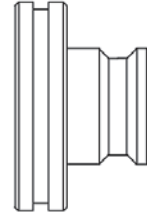
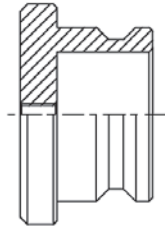

Note A: Viton-Dichtbereich

Note A: Viton-Seal Location

Note B: Bereich für Gewindestift mit Edelstahl-Kette und Edelstahl-Ring am Ende der Kette

Note B: Location For A Threaded Nail With A Stainless Steel Chain And Stainless Steel Ring At The End Of The Chain

Note C: Entlüftungsbohrung

Note C: Air Passage Hole